

FACTSHEET - MPS - 280

Characteristics 20 ft x 8 ft container pontoon

Length O.A.	6.09 m (20ft)
Breadth O.A.	2.44 m (8ft)
Depth	2.44 m (8ft)
Weight	7.6 ton
Deck thickness	8 mm
Watertight bulkhead 1	
Compartments 2	
Manholes 2	
Deckload 6.0 t/m ²	
T (draught) empty 0.51 m	
T (draught) Max. 2.14 m	
Load cap at t Max. 24.1 ton	
Class society	Bureau Veritas
Class Notation	Inland waters Sheltered area Coastal area

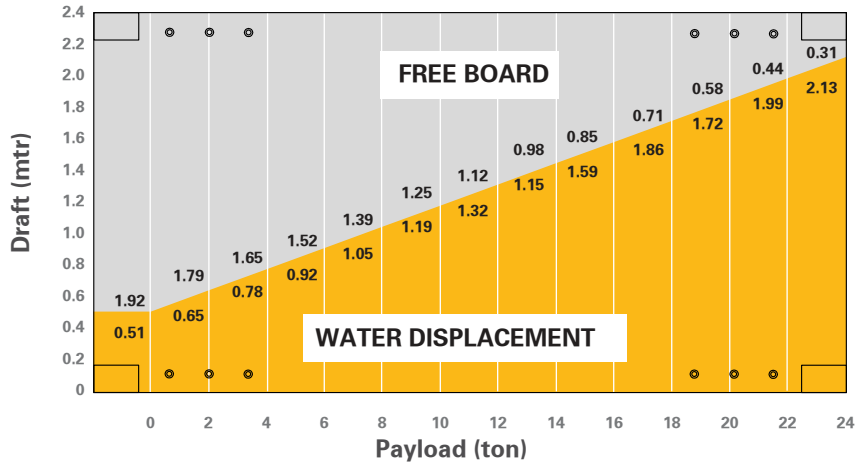

TEKLOCK®

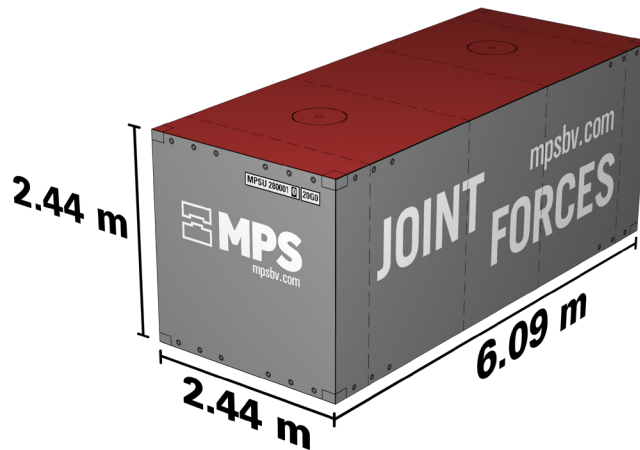
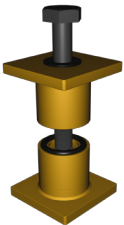

TRANSPORT OPTIONS



BY ROAD



BY SEA



BY RAIL

MPSU 280001 **Q** **20G0**

CSC APPROVAL
 CERTIFICATE

CSC SAFETY APPROVAL			
APPROVAL REFERENCE			
DATE MANUFACTURED			
IDENTIFICATION No.			
MAXIMUM OPERATING GROSS MASS	kg		lbs
ALLOWABLE STACKING LOAD FOR 1.8 g	kg		lbs
TRANSVERSE RACKING TEST FORCE	newtons		
END WALL STRENGTH	NIL		lbs
SIDE WALL STRENGTH	NIL		lbs
NEXT EXAMINATION DATE			